



# Schenectady City School District

Mosaic Associates  
Kersten Lorcher, AIA

Phase I – Capital Project Update

18<sup>th</sup> of May, 2016



# CAPITAL PROJECT UPDATE | Outline

- Group B Projects Status Update:  
Mont Pleasant Middle School  
Oneida Middle School
- Group C Projects Status Update:  
Central Park Middle School  
Howe Elementary  
Van Corlaer Elementary
- Group D Projects Status Update:  
Hometown Health Center @ MPMS  
Hometown Health Center @ SHS  
Ph 1B - CPMS – Exterior Masonry / Roof Repair Project
- Next Steps:  
Critical & Milestone Dates





# CAPITAL PROJECT | Group B

- MPMS – Phases 1B, 1C & 2

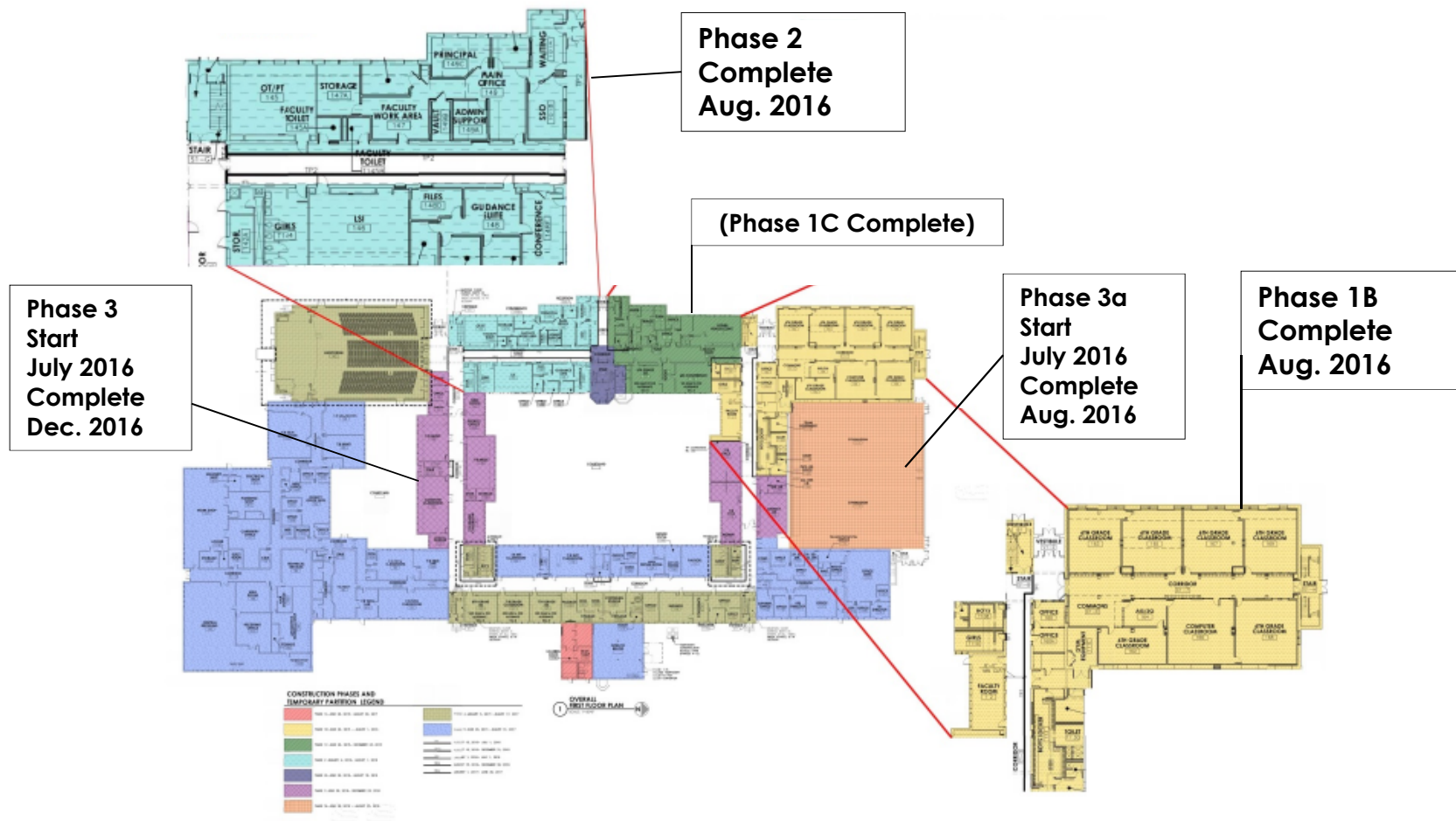



# PROGRESS UPDATE | MPMS

## Second Floor Reconstruction

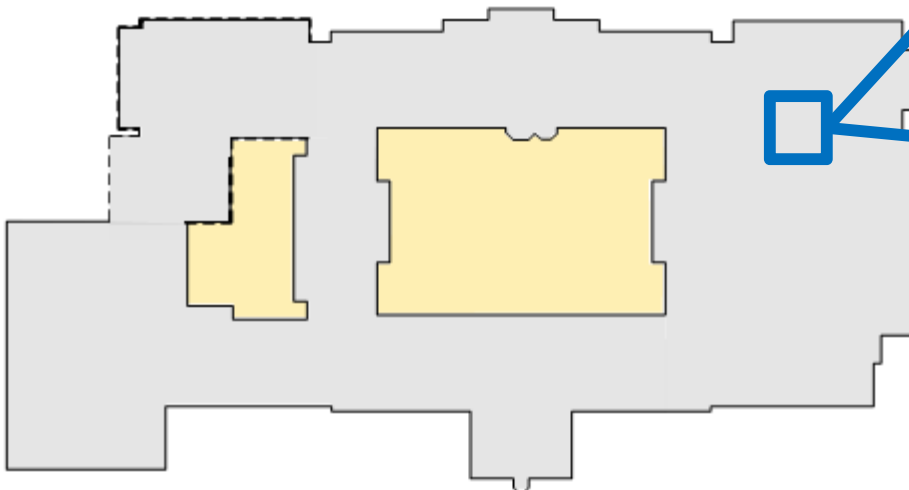

Second Floor Commons Area



# PROGRESS UPDATE | MPMS

## Second Floor Reconstruction

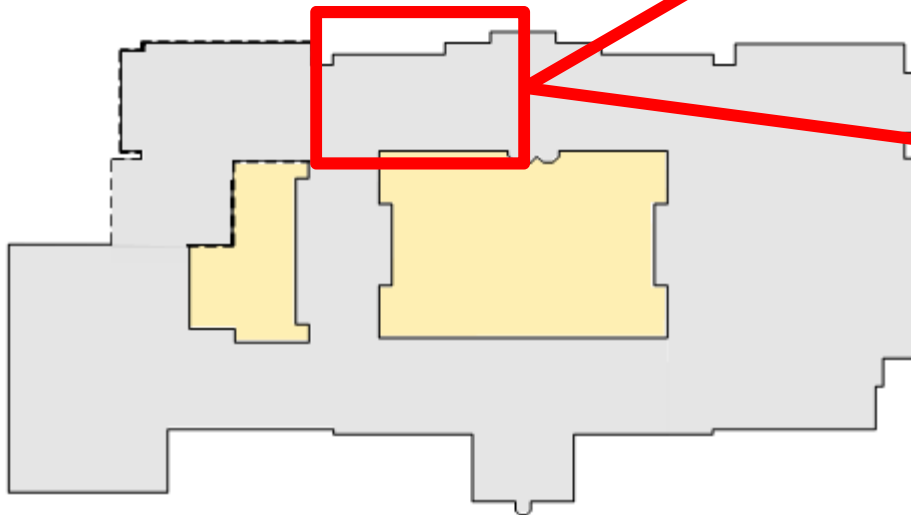

Second Floor Classrooms



# CAPITAL PROJECT | Group B

- OMS – Ground Floor Plan

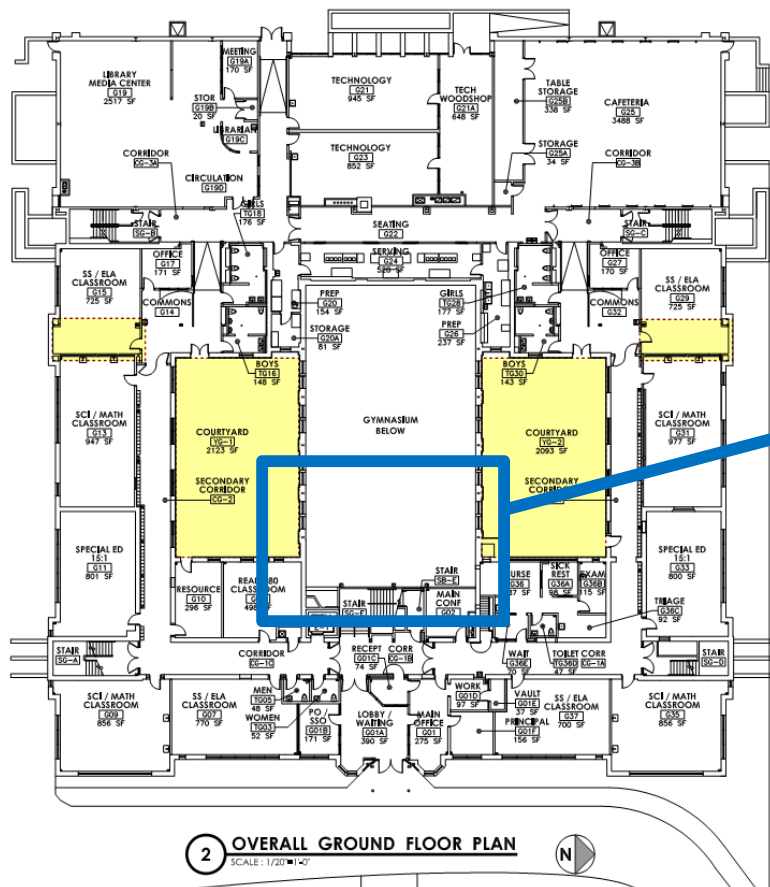

Ground Floor Gym – painting in progress





# CAPITAL PROJECT | Group B

- OMS – First Floor Plan

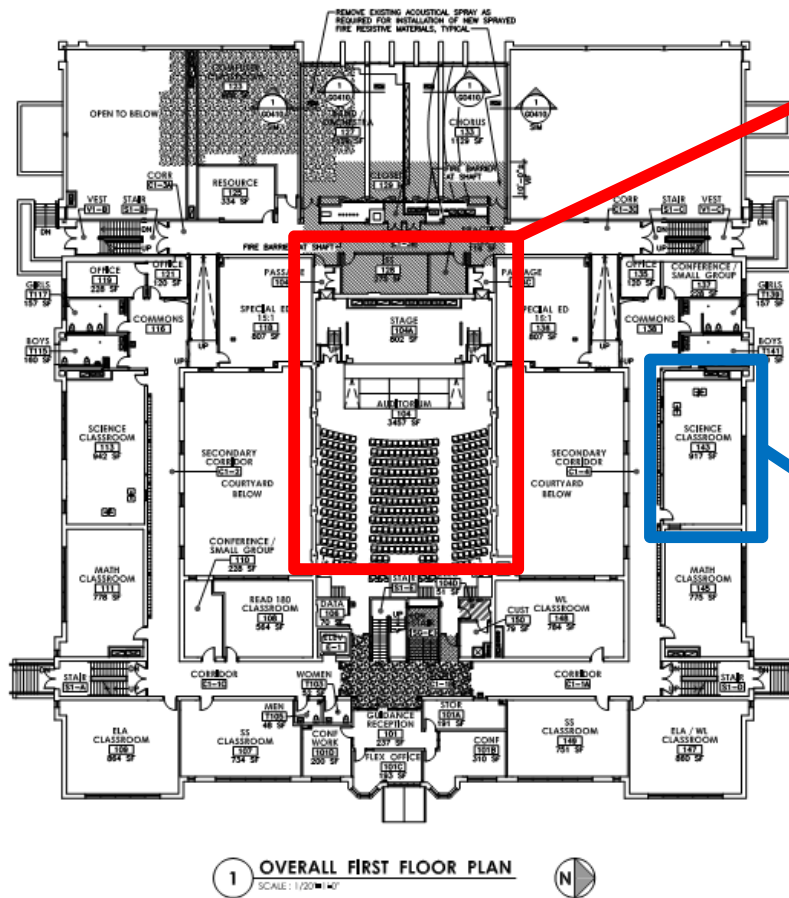

Auditorium New Wood Flooring



Second Floor Science Classroom



## CAPITAL PROJECT | Group C

- CENTRAL PARK MIDDLE SCHOOL –
  - Bids received and Letters of Intent for award have been sent to Contractors.
  - Contracts and product submittals are being processed.







## CAPITAL PROJECT | Group C

- Van Corlaer ES drawings & specifications at NYSED;
  - Responses have been made to architectural comments.
  - Awaiting Engineering review.
  - Project is out to bid.
- Howe ES drawings & specifications have been submitted to NYSED;
  - Architectural & MEP approval received. Awaiting final NYSED approval.
  - Bids have been received. Recommendation pending NYSED approval.





## CAPITAL PROJECT | Group D

- Hometown Health Centers
  - MPMS & SHS:
    - Final pricing received from Contractors; Recommendation to award has been made to Hometown Health; awaiting Letter of Intent to proceed from Hometown Health.
    - Anticipate Summer 2016 construction





## CAPITAL PROJECT | Group D

- Phase 1B - CPMS – Exterior Masonry / Roof Repairs
  - **Bond Referendum – Passed** (unofficial results)





## CAPITAL PROJECT UPDATE | Next Steps & Milestones

- Spring 2016 Anticipate SED approval for Howe and Van Corlaer Elementary Schools.
- June 2016 Anticipate recommendation on HOWE bids and bidding VCES Projects.
- July 2016 Anticipate commencing mobilization and construction at CPMS / HOWE / VCES
- August 2016 District move into OMS & MPMS
- September 2016 Reopen Oneida Middle School;  
Open Mt Pleasant MS & Central Park MS with 6th, 7th & 8th Grades.
- Fall 16 – Spring 17 Construction at MPMS, HOWE & VCES.
- Summer 2017 Construct New bus drop off loop at MPMS.



THANK YOU | Any Questions?

